



Using the Avaya E169 Media Station as a Bluetooth Speakerphone

March 2016
© 2016, Avaya, Inc.
All Rights Reserved.

Introduction

Use this quick guide to set up your Avaya E169 IP Media Station as a Bluetooth speakerphone for your smart device. This guide contains the following information:

- How to assemble the media station.
- How to pair your smart device using Bluetooth.
- How to reset the media station to factory defaults.
- How to get additional support for the media station.

! Important:

For detailed assembly procedures, user procedures, and regulatory information for the Avaya E169 IP Media Station, see *Using the Avaya E169 IP Media Station*.

Avaya E169 IP Media Station parts

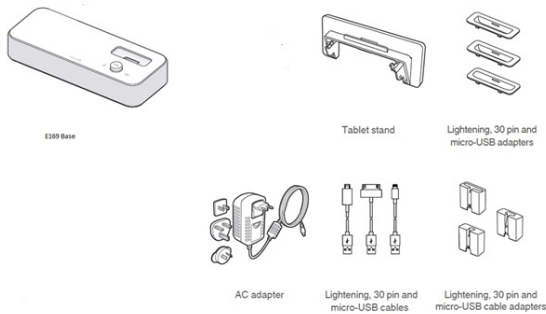

Assembling the media station

1. Remove the parts from the shipping box. Confirm that you have all required parts.
2. Remove any transparent protective film or packing materials from the parts.
3. (Optional) If you want to use the media station to also charge your smartphone, perform the following steps:
 - a. Select the USB cable and cable sleeve that matches your device.

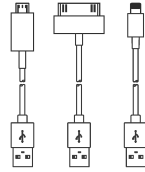

- b. Assemble the USB cable and cable sleeve. The following example shows the Apple lightning cable and cable sleeve.

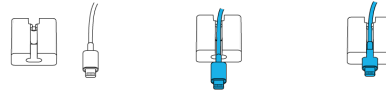

- c. Insert the cable sleeve into the slot from the top of the media station. Use the following diagram to ensure you have the cable sleeve inserted correctly.

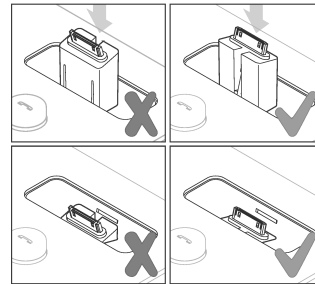

- d. Route the USB cable under the media station and through the cable channels.
- e. Plug the USB connector of the cable into the left USB port at the rear of the media station.
- f. Insert the docking cradle into the base that matches the USB cable that you are using. If your smartphone has a case that does not fit in the cradle, do not install the cradle.



4. (Optional) If you want to use the media station to also charge your tablet, perform the following steps:
 - a. Install the tablet bracket. Ensure that the tablet bracket snaps in all the way in at the bottom of the bracket. When properly installed, the bracket will be at an angle to the media station base.

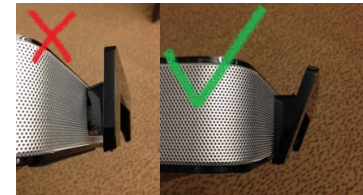
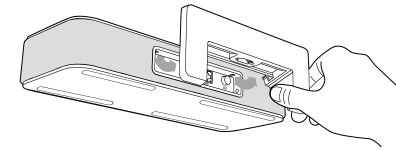



- b. Connect the USB cable to the tablet. You can route the cable through the tablet bracket.
 - c. Plug the USB cable into the left USB connector on the rear of the media station.
5. Plug the AC power adapter into the AC connector on the rear of the media station and into a wall mount socket.
 6. Press the power button on the back of the media station to power up the unit.

Connecting smart devices with Bluetooth pairing

Use this task to make a Bluetooth connection from your smart device and the media station. Once connected, you can use the speakerphone for cellular calls or play music from your smart device.

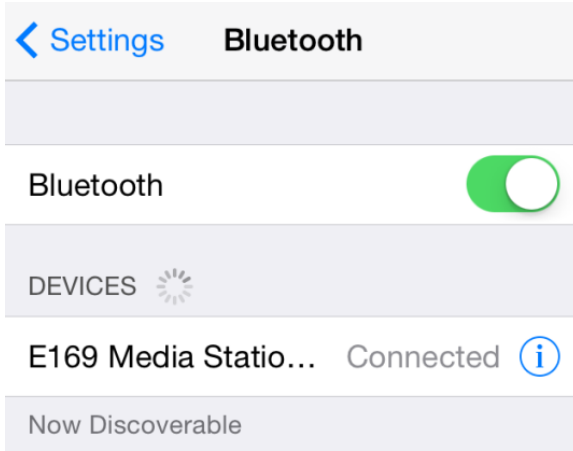
1. Enable Bluetooth on your smart device. For example:



2. Put the media station into pairing mode by pressing and holding the **Call/Volume** button, , on the media station until you hear a single click. After you release the button, the media station plays the message “Pairing mode: waiting for connection.” Your smart device should display a Bluetooth connection with the media station.
3. Tap the E169 Media Station icon on your smart device and confirm that the status is connected. This might take a few minutes.

Removing Bluetooth connections and subscriptions

If you need to switch to another Bluetooth device, you must clear the smart device profile from the media station. You can remove a Bluetooth subscription in either of the following ways:

- Using the media station **Call/Volume** button.
- Using the smart device **Settings** menu.

If you are having problems getting a smart device to connect with the media station, remove the connection before trying to connect again.

Depending on how you remove the Bluetooth connection, you might have to use your smart device Bluetooth menu to disconnect the media station.

Removing connections

1. Using the media station **Call/Volume** button, , press and hold the **Call/Volume** button until you hear two clicks. The media station plays the message “Disconnecting,” followed by a high-to-low tone sound.

Removing subscriptions

2. Using the media station **Call/Volume** button, , press and hold the **Call/Volume** button until you hear three clicks. The media station plays the message “Clearing all subscriptions.”
3. Using the smart device, perform the following actions:
 - a. Select **Settings > Bluetooth**.
 - b. Tap the **Info** icon.
 - c. Tap **Forget this Device**. The system removes the Bluetooth subscription.

Resetting the media station to factory defaults

1. Turn off the media station.
2. Press and hold the **Call/Volume** button, .
3. Turn on the media station or plug in the AC adapter.
4. When the **Mute** icon flashes, release the **Call/Volume** button.
5. Turn the **Call/Volume** button about one click to the right.
6. Verify that the **Mute** and **Voice Mail** icons are flashing one time each. If the **Voice Mail** icon is flashing more than once, turn the **Call/Volume** button counter to the right or left until you see the **Voice Mail** icon flash one time.
7. Push the **Call/Volume** button one time. The media station resets to factory defaults.

Additional support links

Reference	Link
Avaya Media Station support site	https://support.avaya.com/products/P1583/e169-media-station/All
Avaya Media Station Collateral	https://sales.avaya.com/en/general/search-results?q=E169
<i>Avaya E159 and E169 IP Media Station Overview and Specification</i>	http://support.avaya.com/css/P8/documents/101007199
<i>Installing and Maintaining the Avaya E159 and E169 IP Media Station</i>	http://support.avaya.com/css/P8/documents/101007205
<i>Using the Avaya E169 IP Media Station</i>	http://support.avaya.com/css/P8/documents/101007208
<i>Avaya E169 IP Media Station Quick Reference</i>	http://support.avaya.com/css/P8/documents/101007202
Avaya E169 IP Media Station Readme	http://support.avaya.com/css/P8/documents/101010219
Avaya E169 IP Media Station Firmware/ Software	https://support.avaya.com/downloads/download-details.action?contentId=C201555119218640_9&productId=P1583

Regulatory statements

FCC Radiation Exposure Statement

This equipment complies with FCC radiation exposure limits set forth for an uncontrolled environment. This equipment should be installed and operated with minimum distance of 8 in or 20 cm between the radiator and your body. This transmitter must not be co-located or operating in conjunction with any other antenna or transmitter.